

ORDNANCE SURVEY SITEPLAN DATA
© 2011 Crown Copyright
Reproduction in whole or in part is prohibited
without prior permission of Ordnance Survey

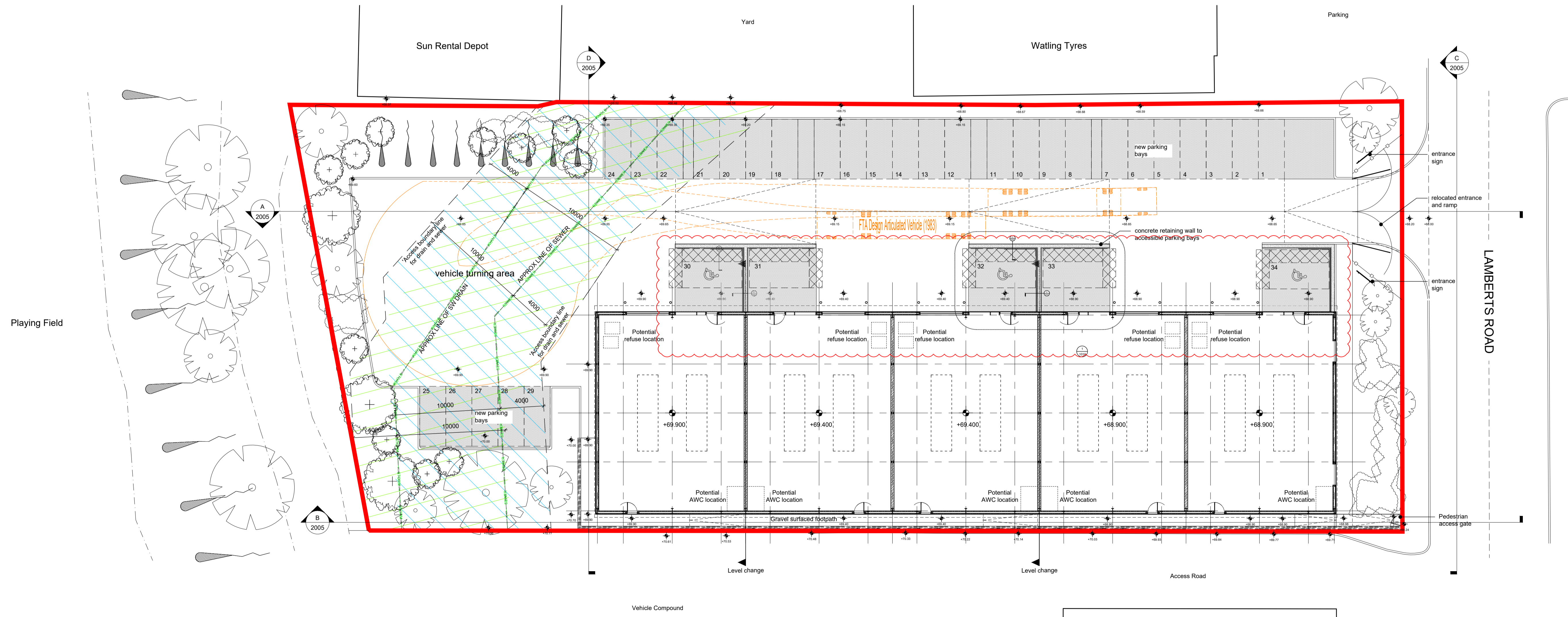

PLEASE NOTE
FOR CONSTRUCTION PURPOSES USE ONLY FIGURED DIMENSIONS. THIS DRAWING MUST ALWAYS BE READ IN CONJUNCTION WITH ALL RELEVANT PROJECT DETAILS. ALL DIMENSIONS MUST BE CHECKED ON SITE PRIOR TO COMMENCEMENT. PLEASE REPORT ANY DISCREPANCY TO THE ARCHITECT OR CONTRACT ADMINISTRATOR

Revisions	MD	TT	Final Issue
T1 22.06.18	MD	TT	Final Issue
T2 20.11.18	MD	TT	Approved scheme, along with adjacent ground levels/ landscaping to minimise environmental impact from reduced level site
T3 22.11.18	TT		Gabions to parking bays omitted in lieu of concrete retaining wall, acc parking bay zone increased in size

NOTE: DRAWING REPLACES PREVIOUS DRAWING 2023_0005_P1. FOR EXTERNAL WORKS SEE DRAWING 2023_1006 +1007

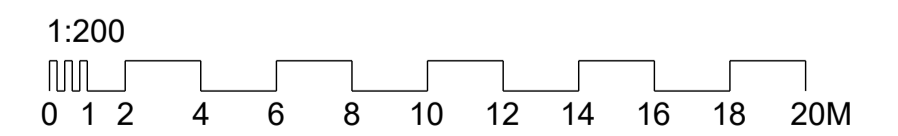

Drawing		Date
Proposed Site Plan		June 18
Project/Client		Scale @ A1
Lamberts Road, North Farm		1:200
Tynatic Properties Ltd & Wealdoval Developments Ltd.		
Job reference / Drawing number	Revision	Purpose of Issue
2023 1005	T3	Tender

HazleMcCormackYoung LLP/Chartered Architects/
Leap House/ Frog Lane/ Tunbridge Wells/ Kent/
TN1 1Y1/ T 01892 515311/ F 01892 515285

