



chartered surveyors  
and property consultants



37-41 Camden Road • Tunbridge Wells • Kent TN1 2PS

Retail / Showroom Premises - To Let - 2562 sq ft

## Location

Camden Road is a retail district leading directly to the centre of town and past the Royal Victoria Place Shopping Centre. This property adjoins Next and has a return frontage into Market Square where there is a Pure Gym. Multi-storey parking is available beyond Camden Square.

## Description

The property comprises a double fronted showroom, over ground and basement floors, linked with an integral staircase. Although the basement is predominately a showroom, there is also storage and staff areas, including ladies and gents' WCs.

Consideration will be given to leasing no.37 (left hand side) separately.

## Floor Areas

Ground – Retail -	1346 sq ft (125 sq m)
Basement - Retail -	841 sq ft (78 sq m)
Basement - Ancillary -	375 sq ft (35 sq m)
Total area -	<b>2562 sq ft (238 sq m)</b>

## Guide Rent

£50,000 per annum exclusive of all other outgoings.

## Lease Terms

A new lease on full repairing and insuring terms is available.

## Business Rates

Rateable Value is £34,500 – for the whole.

## Viewing Arrangements

Strictly by appointment and accompanied.

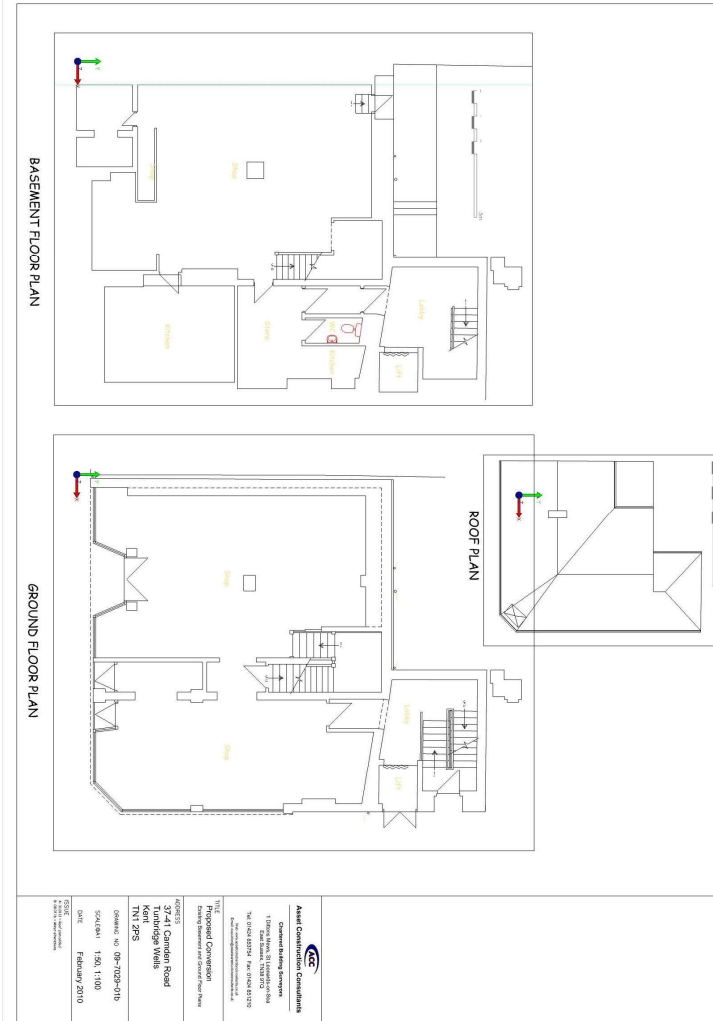

chartered surveyors  
and property consultants

COMMERCIAL

Contact Rupert Farrant  
or Julie Chalmers on  
**01892 552 500**  
rupert@durlings.co.uk  
julie.chalmers@durlings.co.uk  
www.durlings.co.uk



22 Mount Ephraim Road  
Tunbridge Wells  
Kent TN1 1ED

Disclaimer - See Website - [durlings.co.uk](http://durlings.co.uk)